



1 Langton house Cottage Close, Harrow, Middlesex, HA2 0HG  
£1,895 Per Month



## 1 Langton house Cottage Close, Harrow, Middlesex, HA2 0HG

**£1,895 Per Month**

Nestled within the prestigious gated development of Cottage Close, this luxurious 1st-floor apartment enjoys an enviable location in Harrow on the Hill, Greater London. The historic High Street of Harrow on the Hill lies just a short distance away, offering a charming blend of heritage and modern amenities. The development itself spans approximately 5 acres of meticulously landscaped grounds, creating a serene oasis amidst the bustling city.

As you step inside, you'll be greeted by an elegantly furnished living space. The apartment boasts two spacious double bedrooms, each providing a comfortable retreat. The master bedroom features an en suite bathroom, ensuring privacy and convenience. The second bathroom serves the additional bedroom and guests.

The heart of the home is the modern fully fitted kitchen. Equipped with sleek appliances and ample storage, it invites culinary creativity and delightful meals. Imagine preparing breakfast while sunlight streams through the windows, casting a warm glow over the countertops.

The large dual aspect lounge is a highlight of this apartment. With its expansive windows, it offers breathtaking views of both the beautifully manicured gardens and the iconic London skyline. Whether you're unwinding after a long day or entertaining friends, this space provides a sense of tranquility and sophistication.

Residents of Cottage Close enjoy exclusive access to a leisure complex within the development. The gymnasium allows for invigorating workouts, while the communal garden beckons for leisurely strolls or picnics.

For added convenience, there's an allocated car park, ensuring stress-free parking.

In summary, this fully furnished apartment combines elegance, comfort, and convenience. Whether you're a professional seeking a peaceful retreat or a couple looking for a stylish home, Cottage Close offers an exceptional lifestyle. Don't miss the opportunity to make this remarkable apartment your own!

EPC Rating: D & Council Tax Band: F



## Floor Plans

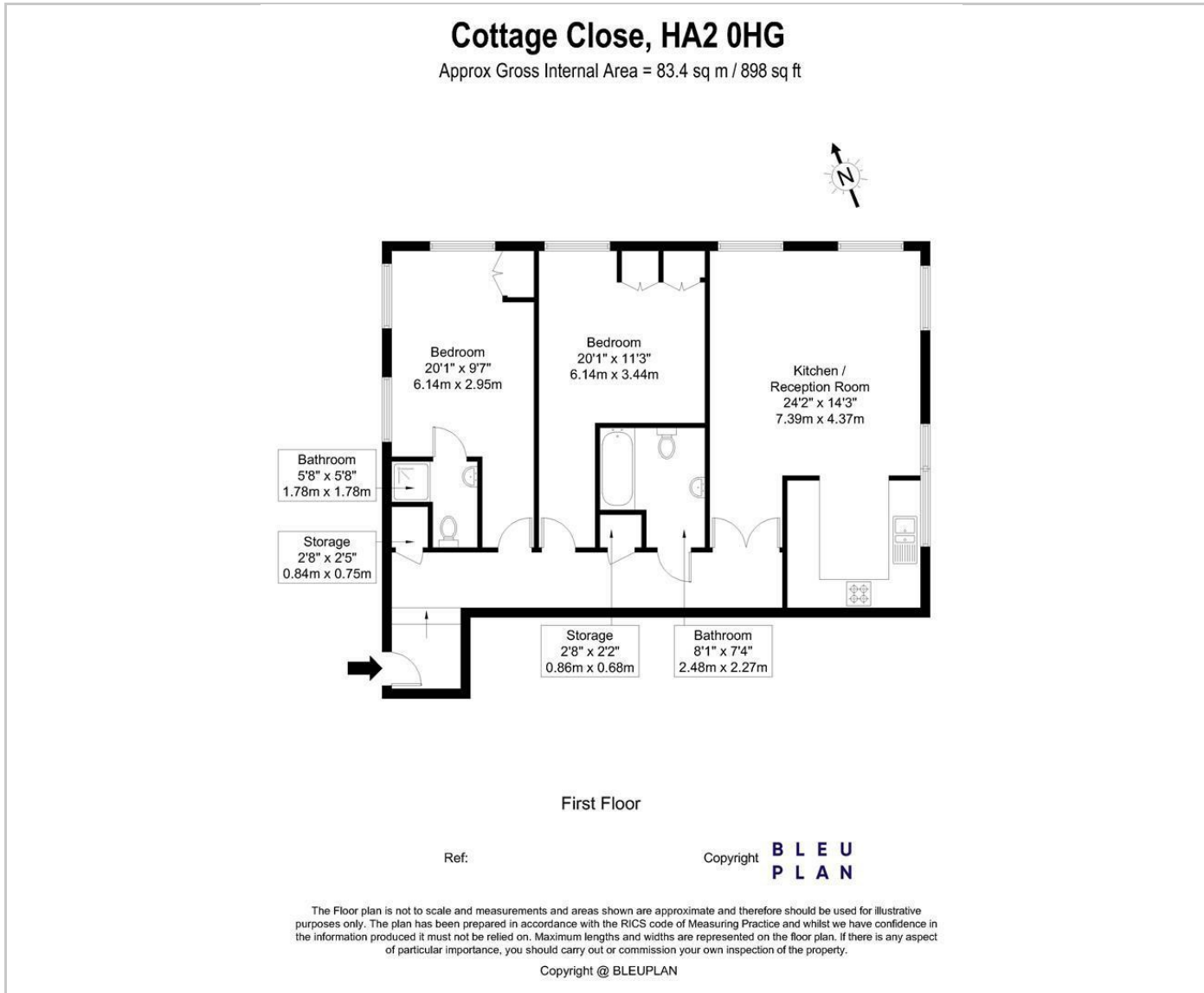

## Area Map

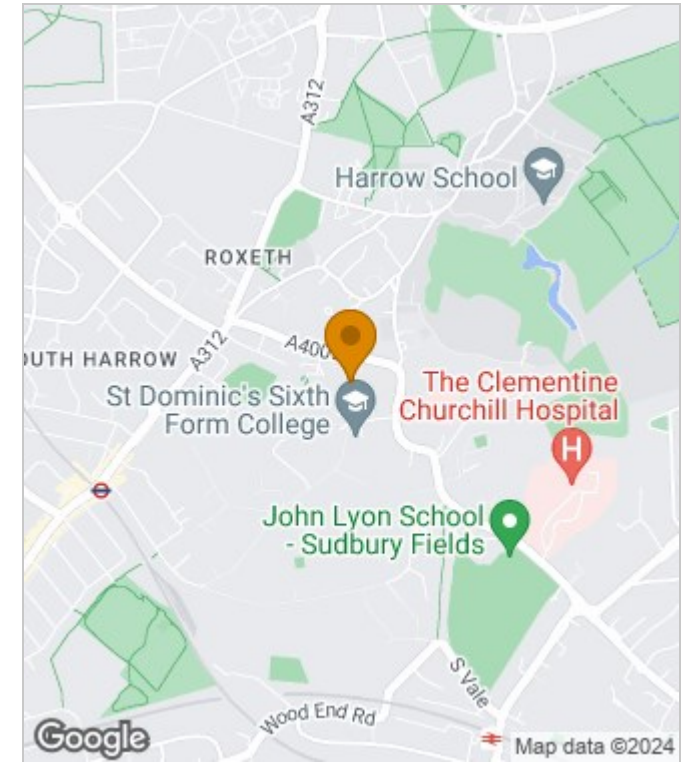

## Energy Performance Graph

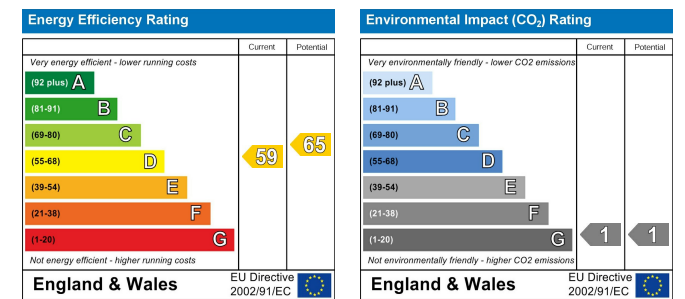

These particulars, whilst believed to be accurate are set out as a general outline only for guidance and do not constitute any part of an offer or contract. Intending purchasers should not rely on them as statements of representation of fact, but must satisfy themselves by inspection or otherwise as to their accuracy. No person in this firms employment has the authority to make or give any representation or warranty in respect of the property.